

Flow Rates Peristaltic Pump

3 years warranty



Features

- Large flow rate, high precision, intelligent control of liquid transferring.
- Servo motor drive, accurate control, strong driving force.
- 304 stainless steel housing, the first choice for high level industrial sites.

Model Number

- V6-3L/DZ25-3L
- V6-6L/DZ25-6L
- V6-12L/YZ35

Technical Specifications

Flow rate range	V6-3L: 0.211~3600 mL/min	Start/stop,direction signal	Passive switch signal, such as foot pedal switch	
	V6-6L: 0.3~6000 mL/min		Active switch signal: 5V, 12V and 24V for option	
	V6-12L: 0.00069~12 L/min		RS232, RS485 support MODBUS protocol (RTU mode)	
Speed range	0.1-600 rpm	Communication interface	Output interface	
Speed resolution	0.01 rpm	Power supply	Output motor working status (Open-Collector output)	
Flow rate resolution	0.01 mL		AC 220V±10% 50Hz/60Hz (standard)	
Flow rate accuracy	< ±0.5%		AC 110V±10% 50Hz/60Hz (optional)	
Back suction angle	0-360°	Drive dimension	V6-3L: 223×152×231mm	
Outlet pressure	0.3 Mpa		V6-6L: 283×192×274mm	
Motor type	Servo motor		V6-12L: 302×222×331mm	
Display	Industrial grade 4.3" color LCD display	Drive weight	V6-3L: 5.02kg; V6-6L: 7.85kg; V6-12L: 13.14kg	
Control method	Touch screen and Mechanical keypad		Power consumption	V6-3L: <80W ; V6-6L: <180W ; V6-12L: <300W
Keypad lifetime	300,000 times		Environment temperature	0-40°C
External speed control signal	0-5V,0-10V,4-20mA for option	Relative humidity	< 80%	
		IP rate	IP31	

Product Composition and Flow Rate Range

Drive	Motor Type	Pump Head	Tubing Size	Speed Range(rpm)	Flow Rate(mL/min)
V6-3L	Servo Motor	DZ25-3L	15#, 24#, 35#, 36#	0.1-600	0.211~3600
V6-6L		DZ25-6L	15#, 24#, 35#, 36#		0.3~6000
V6-12L		YZ35	26#, 73#, 82#		0.69~12000



V Series peristaltic pump has various external control interface, can meet different equipment supporting requirements.

External control interface definition

1. Analog signal input port: Choose the external control speed signal from the external control setting interface. Turn on the external control speed function, control the motor speed range through the analog signal.
2. Internal isolation 5VDC output.
3. External control start/stop,direction signal input port: active signal input.
4. R/S1 external control start/stop signal input port: passive signal input.
5. Motor running status output port: output current running status of the motor.
6. RS232 communication interface: choose RS232 in communication setting interface, this port is effective.
7. RS485 communication interface: choose RS485 in communication setting interface, this port is effective.

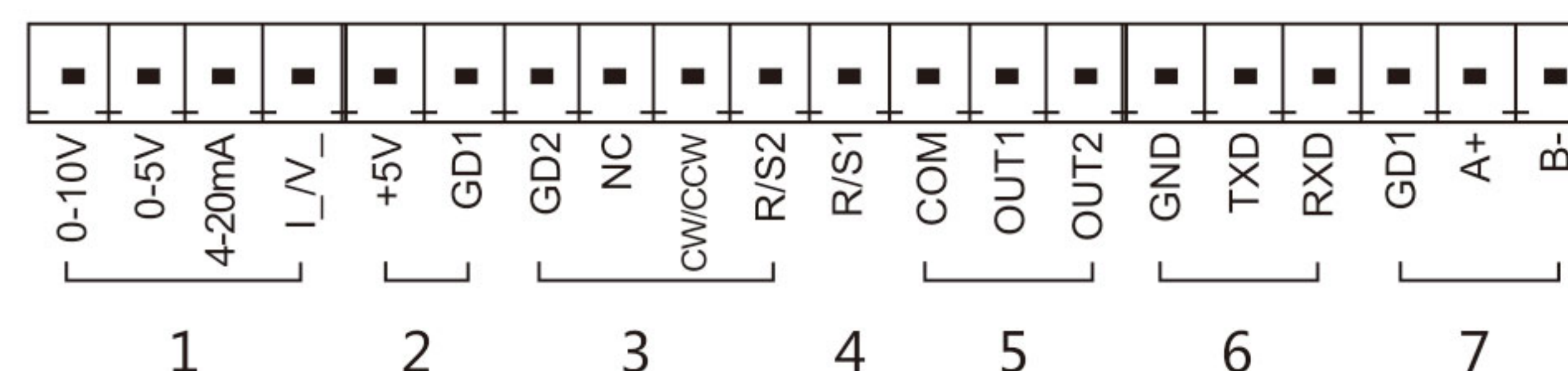

V Series peristaltic pump external control setting interface.

Choose external control start/stop,direction signal

1. Can respectively set external control start/stop or reversing switch whether effective or not.
2. Can choose control mode according to requirement: pulse mode or level mode.
3. Can set the foot switch whether effective or not.
4. Can choose switch value signal 's high level values according to customers' main control equipment: 5V(default), 12V,24V.

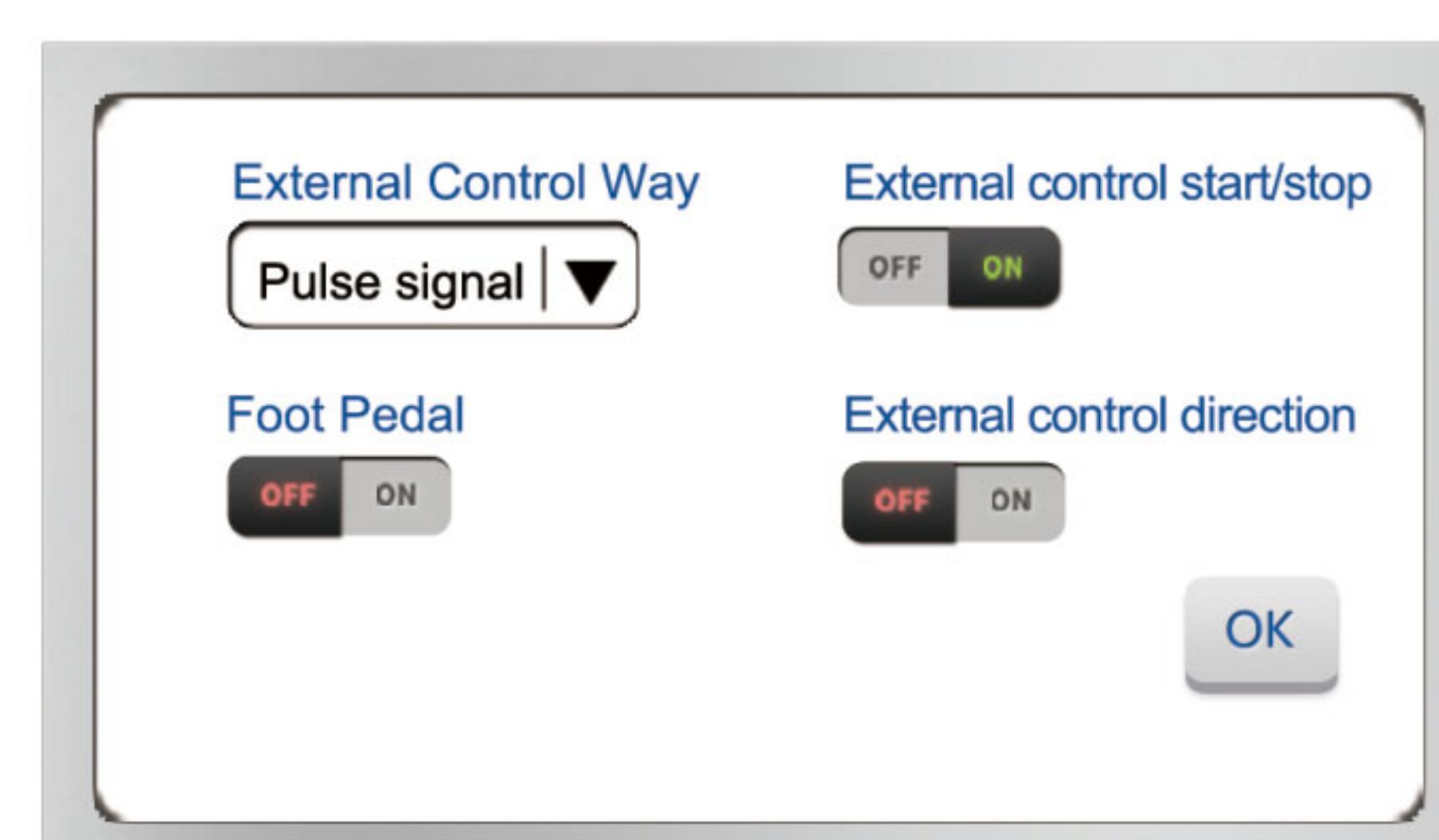

Programmable external control speed setting

1. Can choose analog signal source according to requirements: 0-5V, 0-10V, 4-20mA.
2. When the signal source is chosen, can choose maximum speed and minimum speed which corresponding to the signal source's maximum value and minimum value according to actual demand, to reach userdefined rotate speed range purpose.
3. Working speed limit is at the situation that the linear relation of analog quantity signal and rotating speed keeps invariant, set peristaltic pump's maximum working rotate speed. This setting can avoid production accident caused by sudden change of transfer fluid amount with the sudden change of external analog signal.

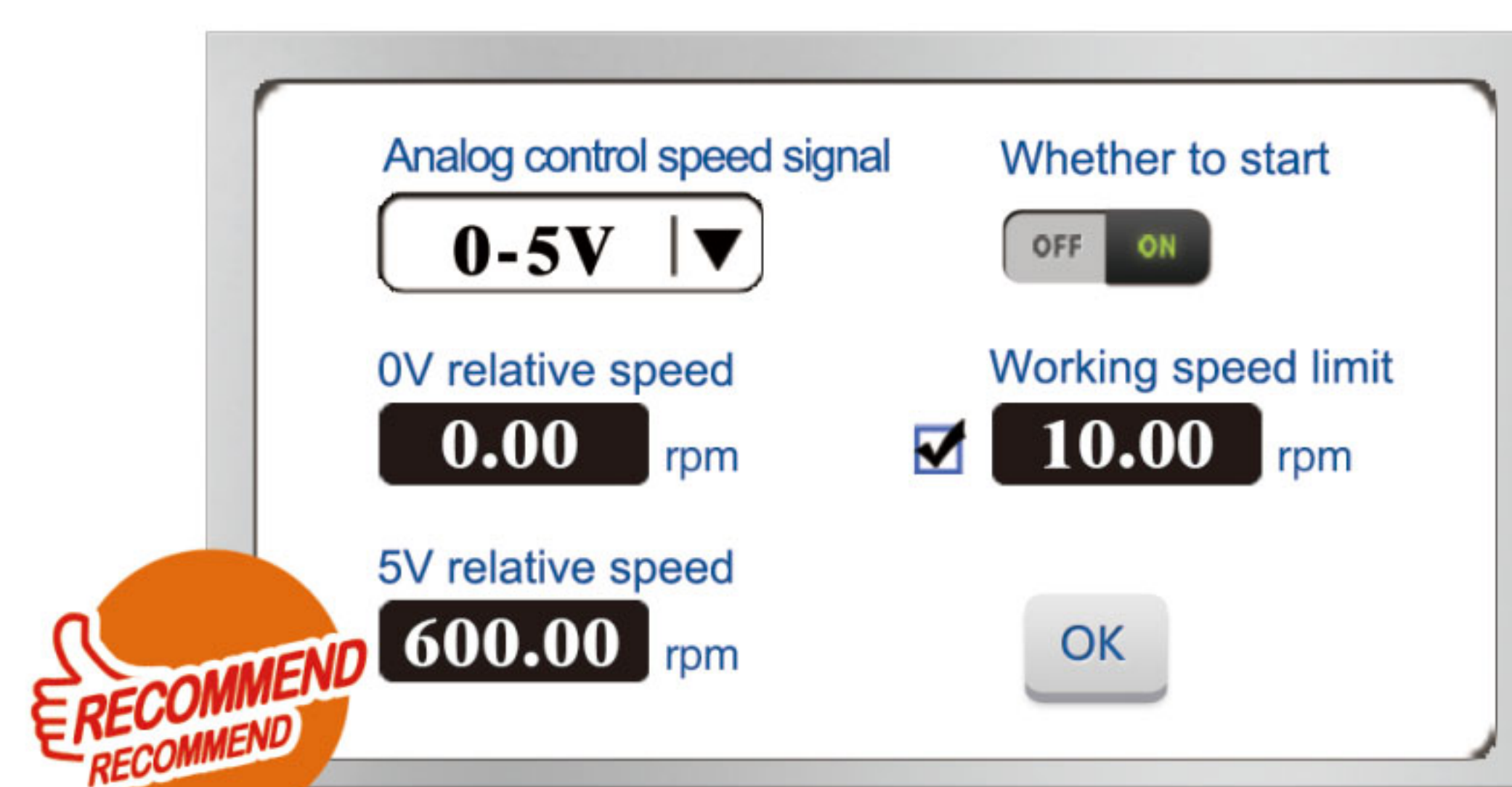

Communication setting

1. Support RS232 and RS485 interface, can be chosen in software interface.
2. Support various Baud rate : 2400bps, 4800bps, 9600bps, 19200bps.
3. Can choose standard modbus communication protocol or Shenchen communication protocol to control, modbus communication protocol is suitable to match with industrial site HMI, PLC or other upper computer which support standard modbus communication protocol; Shenchen communication protocol is suitable to match with single chip micro computer or upper computer on computer programme.

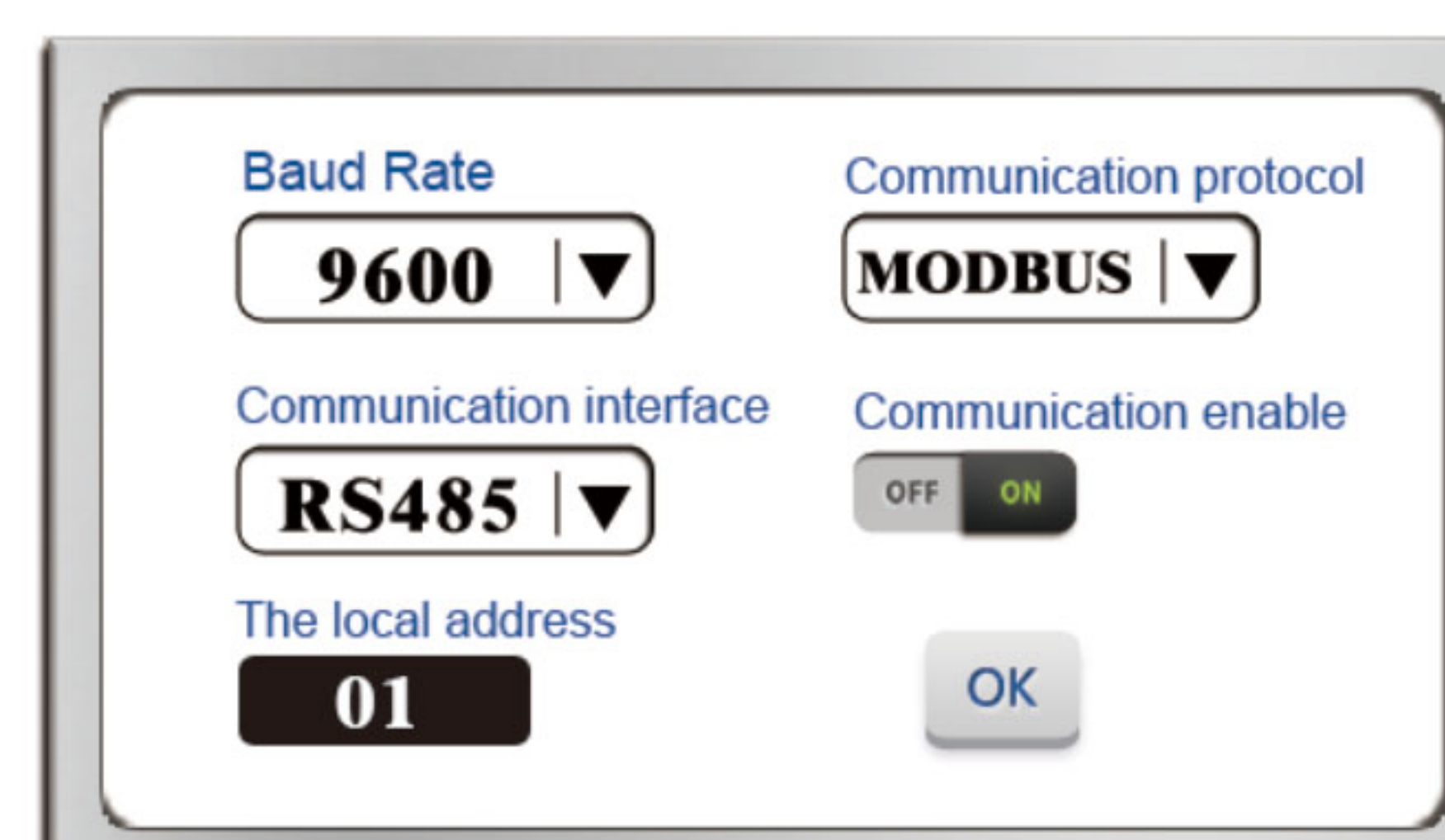

Dimension Drawing (Unit: mm)

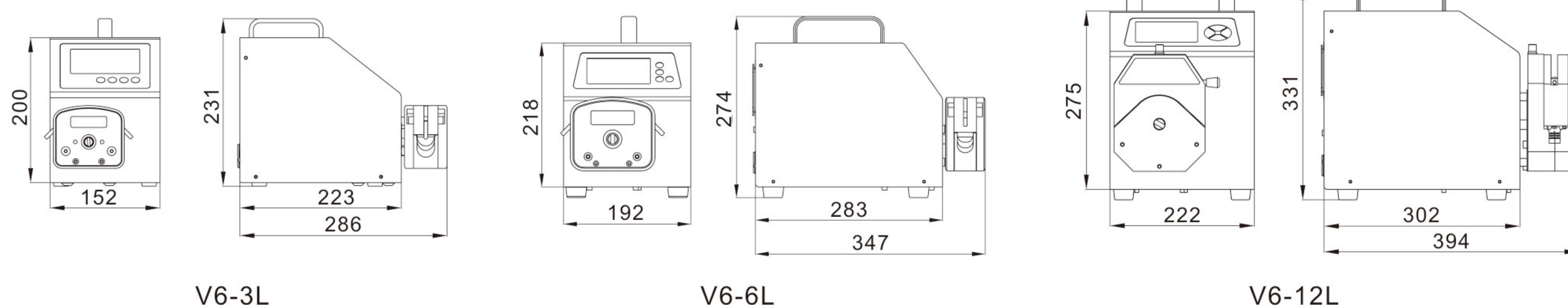

Fast Load Pump Head

DZ25-3L, DZ25-6L



Product Introduction

Easy operation, change tube rapidly. The house material is PPS (polyphenylene sulfite). 304 stainless steel rollers. DZ25 pump head use 2.4mm wall thickness tube, the flow rate range is 0.211-6000mL/min. This pump head is suitable for high viscous liquid which include granule and floc. It also suitable for high pressure request. New cartridge structure design, can use the special connector, connect low cost tubing outside the pump head to save cost; also can use flexible tube clamp, meet hygiene requirement.

Model Number

DZ25-3L, DZ25-6L(Aluminum Alloy)/(PPS)

Dimension Drawing (Unit: mm)

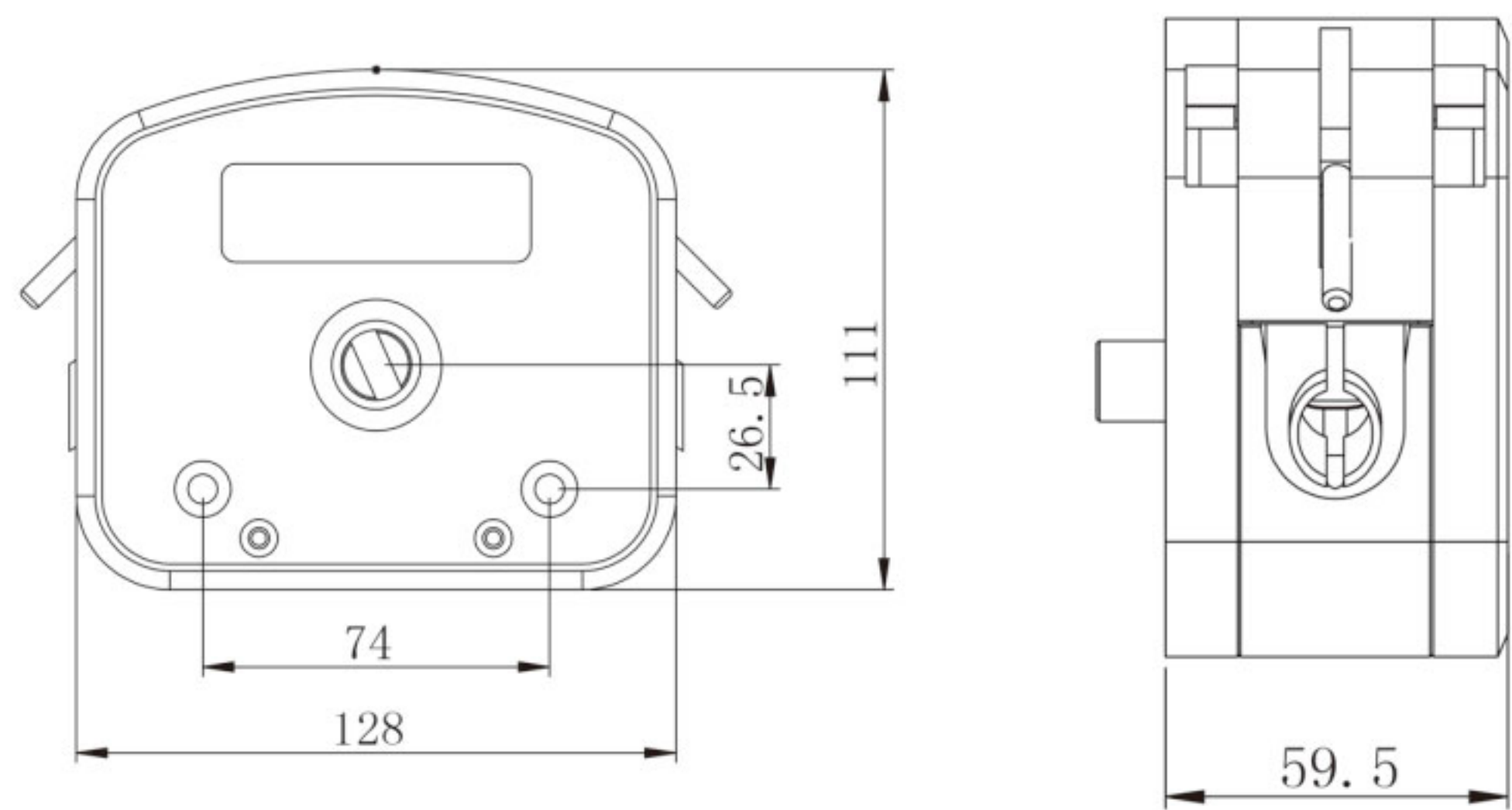

DZ25-6L Dimension

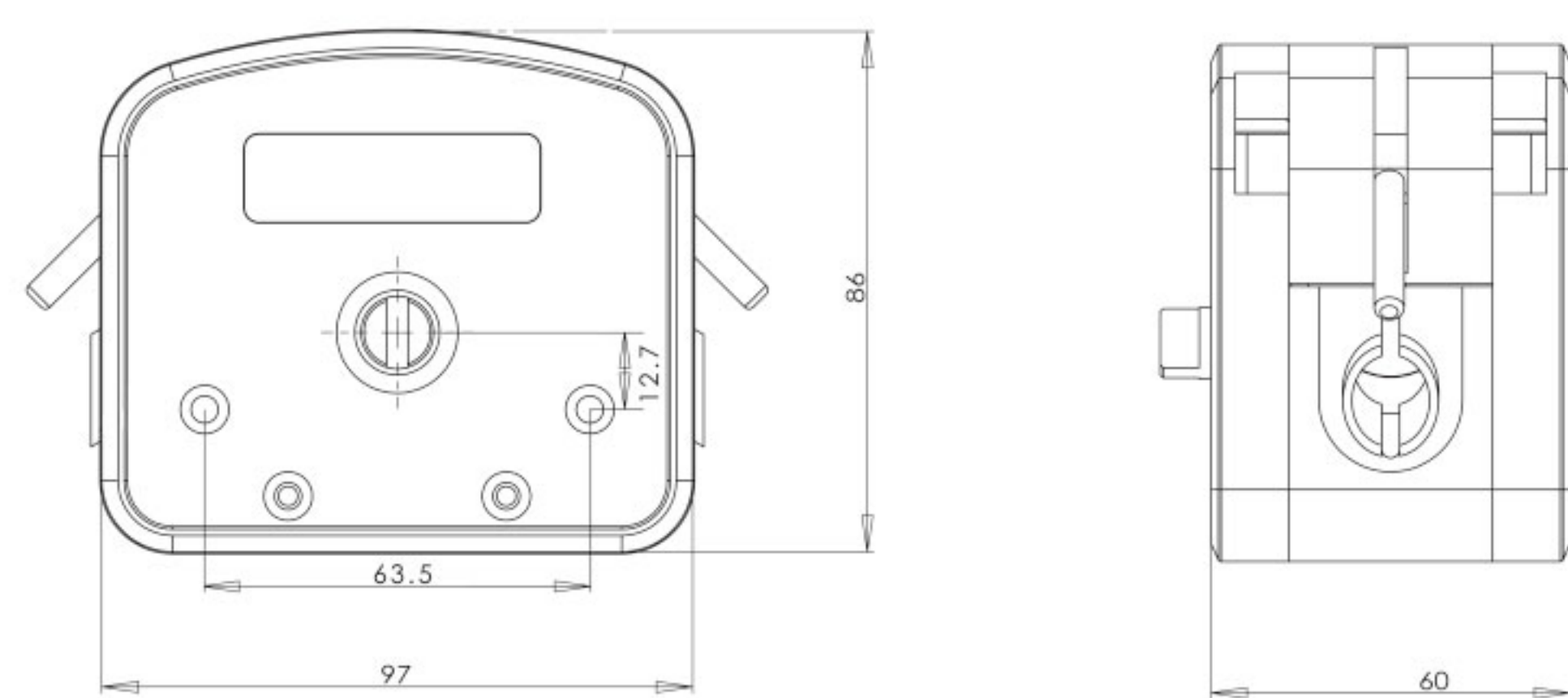

DZ25-3L Dimension

Tubing Installation Procedure

1. Lift both side levers, take off the upper block.



2. Put the tubing with cartridge or connector into pump housing.



3. Install the upper block, put down the levers to lock the block.

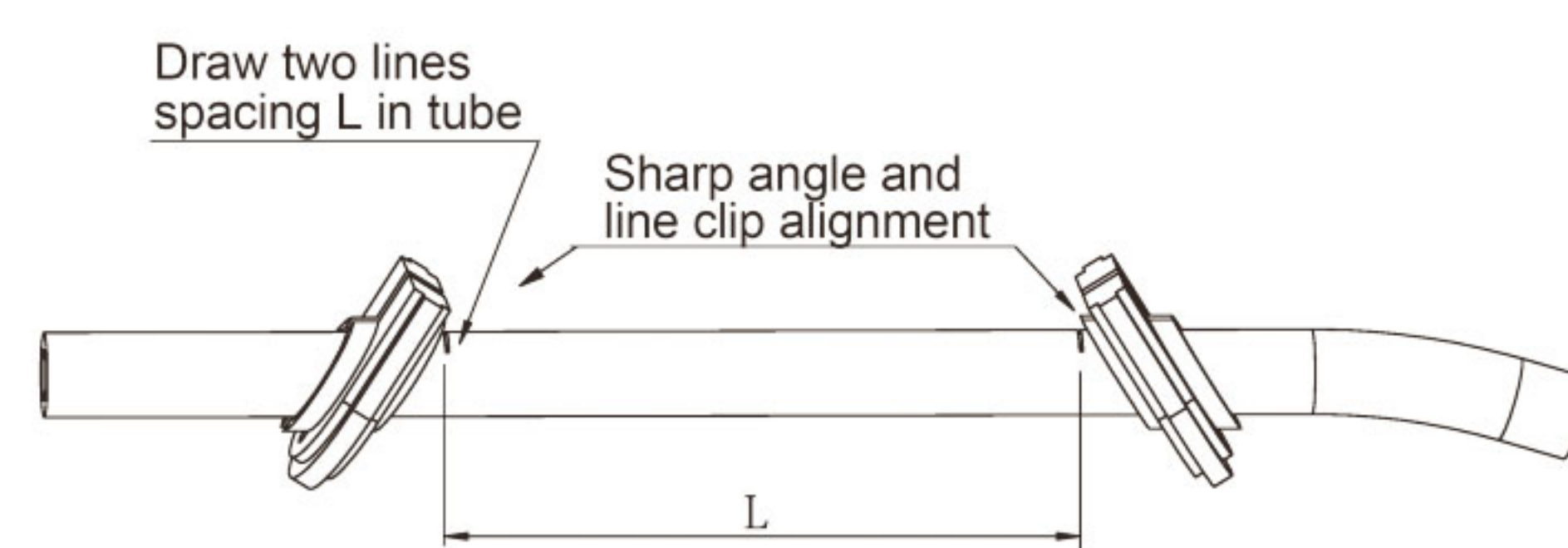

Tubing Clamp

DZ25-6L: the tubing length is 125mm between both tubing clamps.
DZ25-3L: the tubing length is 90mm between both tubing clamps.

Technical Specifications

Model No.	Housing Material	Tubing Clamp Material	Tubing		Flow Rate (mL/min) (0.1-600rpm)	Weight (kg)
			Tubing Sizes	ID x Wall Thickness		
DZ25-6L	Aluminum alloy/PPS	PP	15#	4.8 x 2.4(mm)	0.3~1800	1.86/0.86
			24#	6.4 x 2.4(mm)	0.55~3300	
			35#	7.9 x 2.4(mm)	0.8~4800	
			36#	9.6 x 2.4(mm)	1~6000	
DZ25-3L	PPS	PP	15#	4.8 x 2.4(mm)	0.211~1264	0.5
			24#	6.4 x 2.4(mm)	0.385~2310	
			35#	7.9 x 2.4(mm)	0.508~3050	
			36#	9.6 x 2.4(mm)	0.6~3600	



Easy Load Pump Head

YZ35-PPS, YZ35(Aluminum Alloy)



Product Introduction

YZ35 pump head with aluminum alloy or PPS housing material. 304 stainless steel rollers assembly achieve high precision transferring liquid. Adaptive tubing cartridge structure makes it more easy to load the tubing.

YZ35 Pump Head Tubing Holder Advantages

- 01/ Fix the tubing; lower the tubing shaking during working; **improve the stability and accuracy of flow rate.**
- 02/ Prevent the tubing wear, **extend the tubing lifetime.**

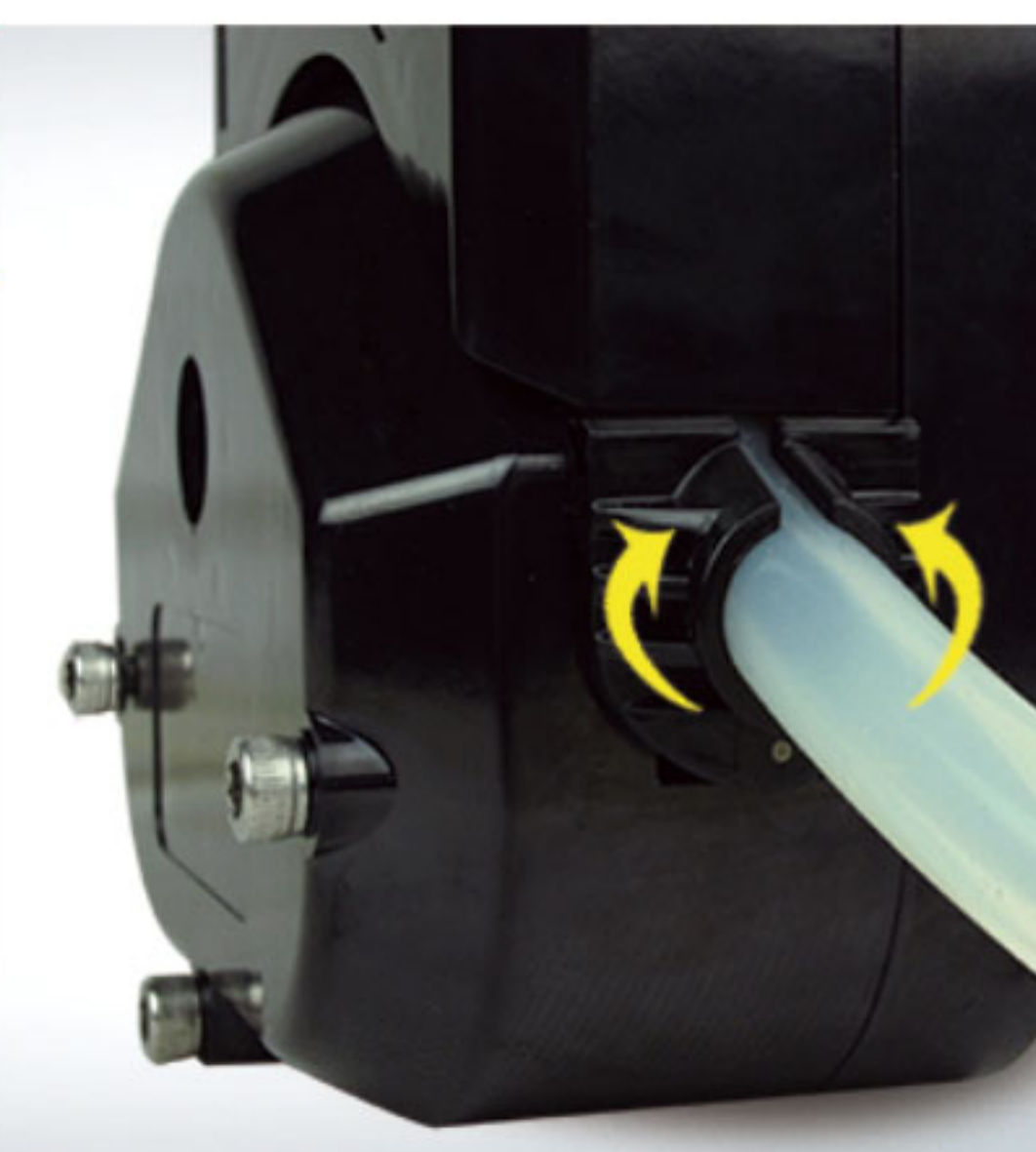

Model Number

| YZ35-PPS, YZ35(Aluminum Alloy)



Dimension Drawing (Unit: mm)

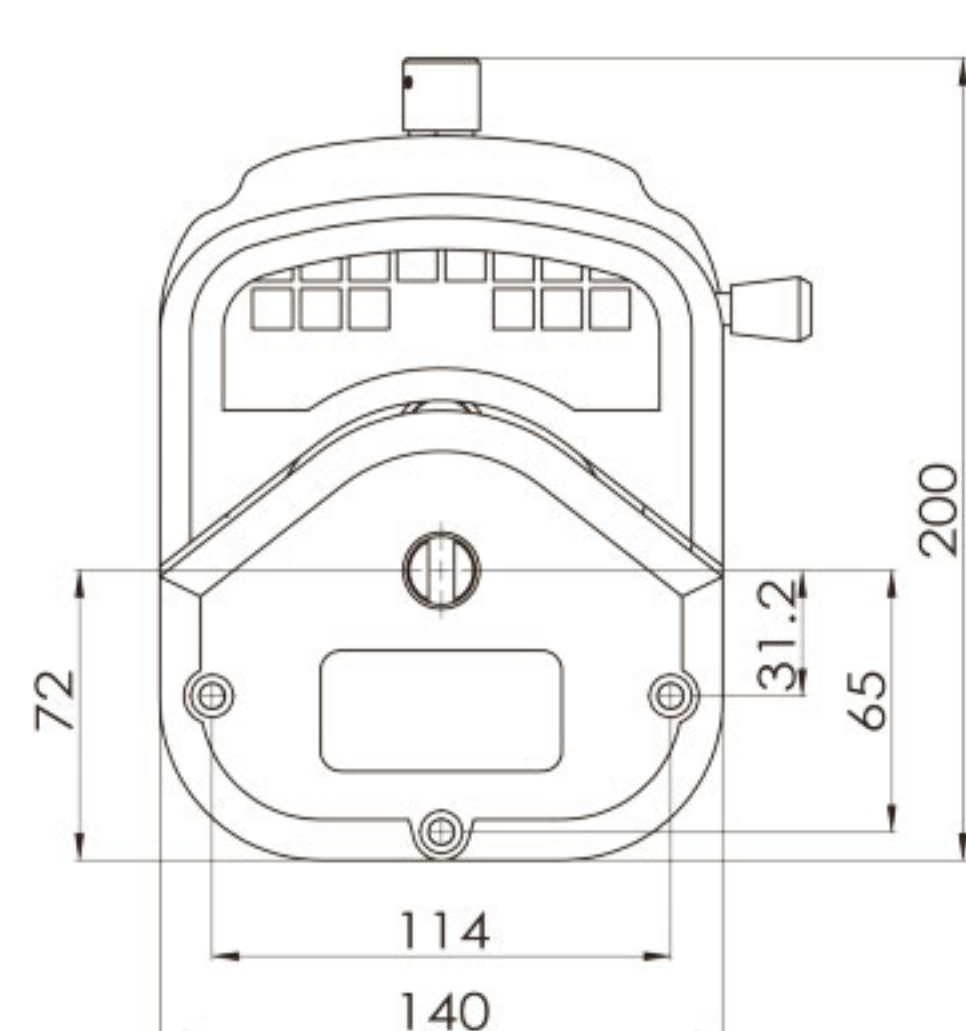

YZ35-PPS

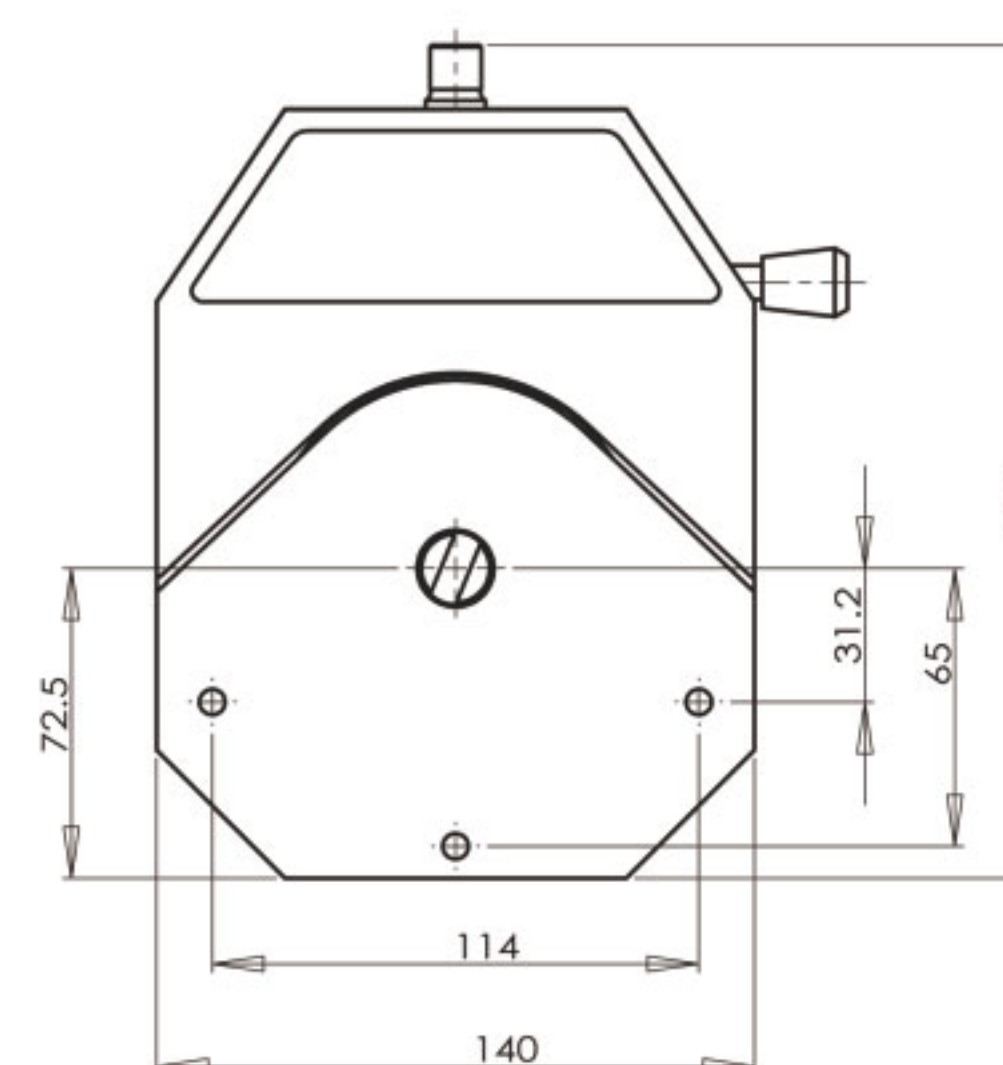
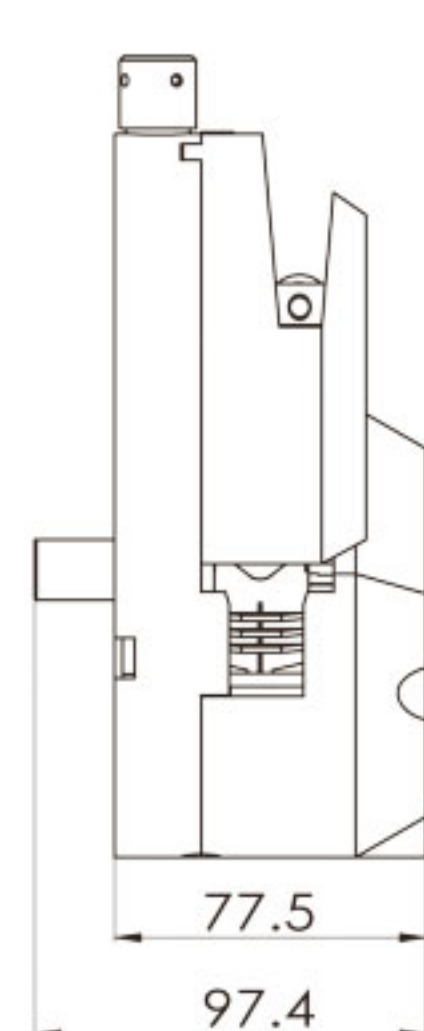

YZ35-Aluminum Alloy

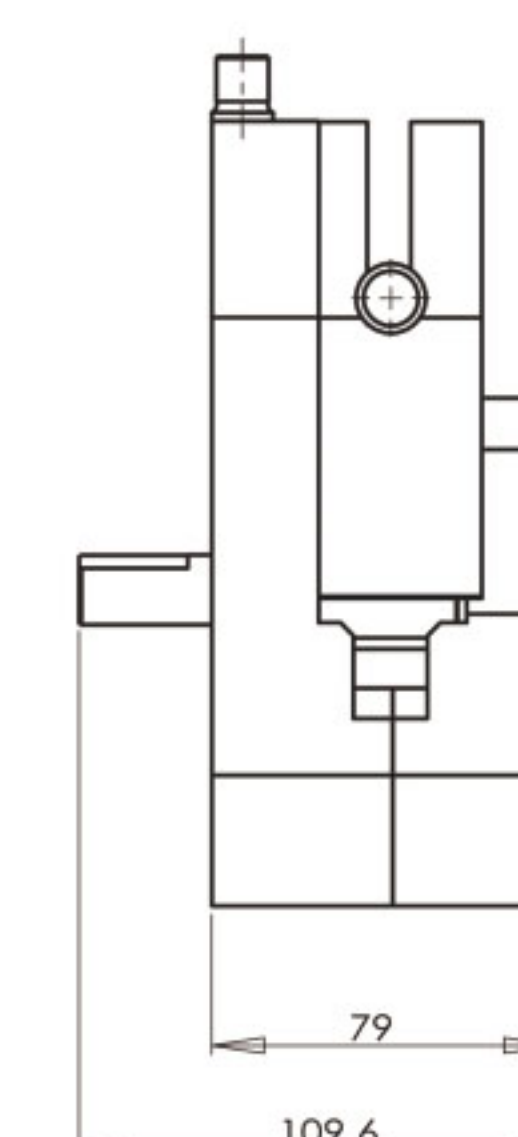

OEM-J24 Series/YZ35

Product Introduction

OEM-J24 use AC gear motor drive, YZ35 pump head is very easy to install tubing. Suitable for laboratory sampling, filling, ultrafiltration, big flow rate pumping and cement additives. It can be used separately, also can combine with other equipment.



Dimension Drawing (Unit: mm)

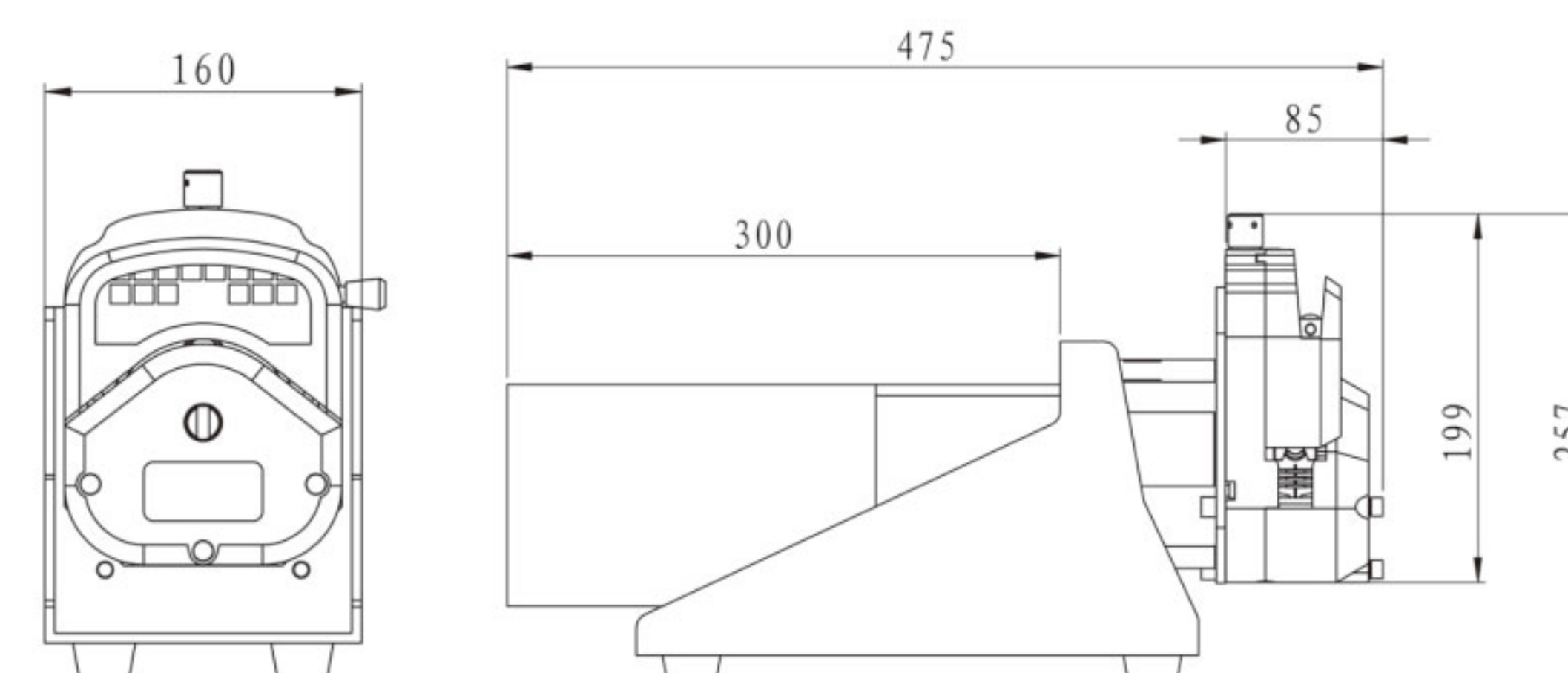

Technical Specifications

Pump Head	Tubing	ID×Wall Thickness(mm)	mL / r	Flow Rate(mL/min) (0-600rpm)	Power Supply	Motor Type	Material/Weight(kg)	
							Aluminum Alloy	PPS
YZ35	26#	6.4×3.3	6.9	<4200	Three phase 220V/380V for option	AC motor with fixed speed or adjustable speed	4.36	1.50
	73#	9.6×3.3	12.3	<7400				
	82#	12.7×3.3	20	<12000				

